

4

Gantry upright (left)

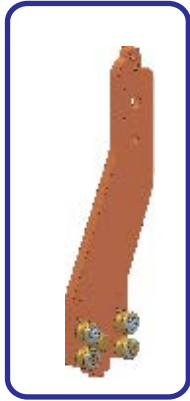

4.1

2	23	27	36	41
1x	2x	2x	2x	3x
	for M3	for M8	M3 x 14	M6 x 10

26	43	55	56	59
2x	2x	2x	2x	1x
for M6	M6 x 25	M6 x 10		

Use 4 track roller bags

20	53	57
8x	4x	4x
Keep parts in each bag together!		

EXTRACT FROM CONSTRUCTION MANUAL

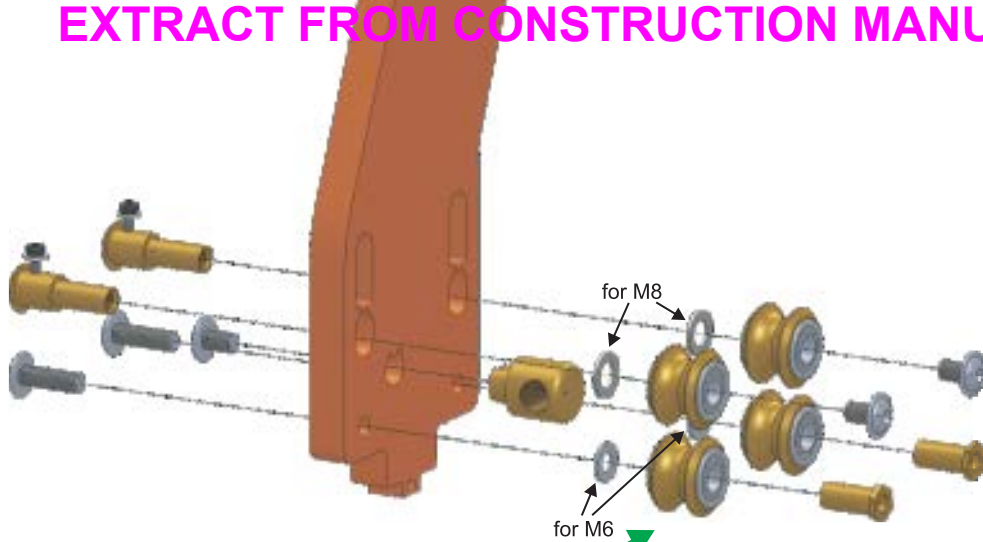

4x

Use L-shape Allen wrench. Must tighten firmly!

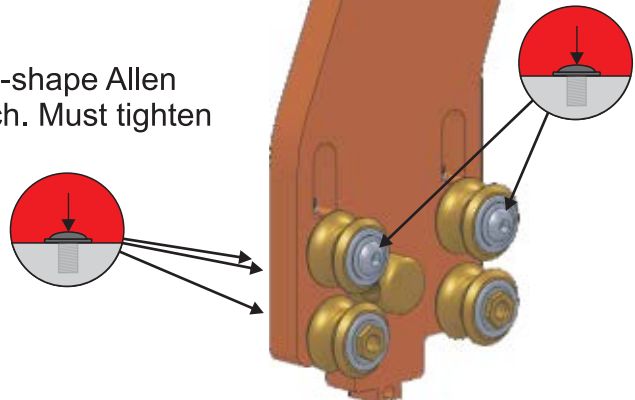

4.2

30
1x

35
1x
M4 x 25

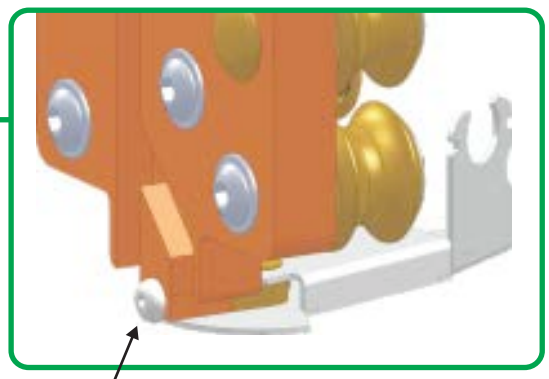
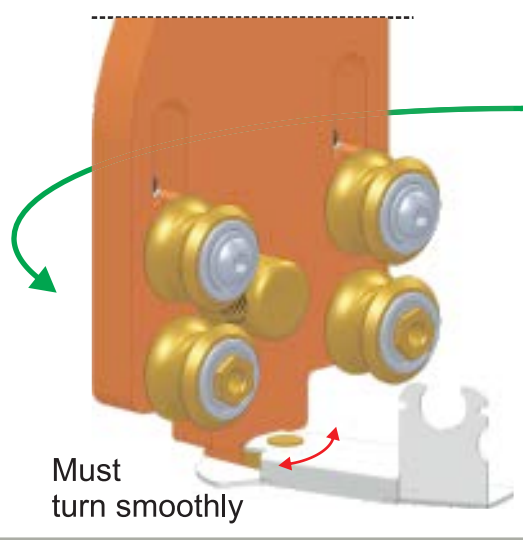
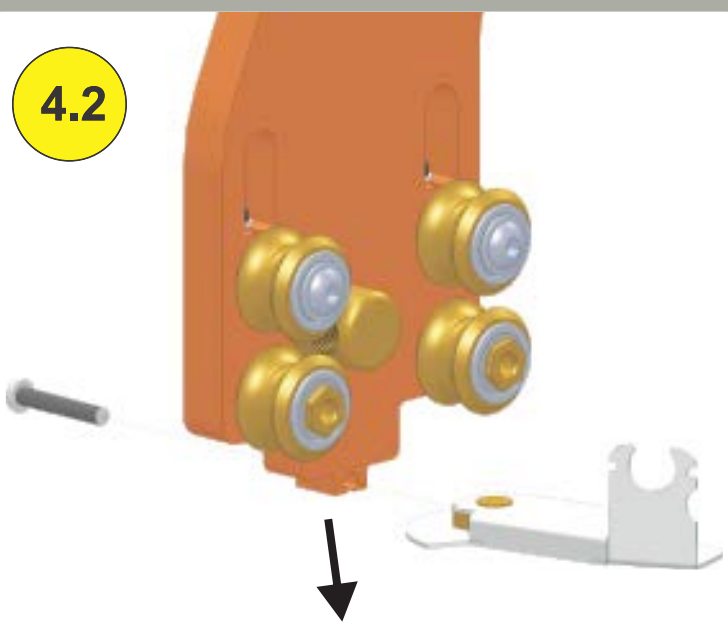

4.3

10
1x

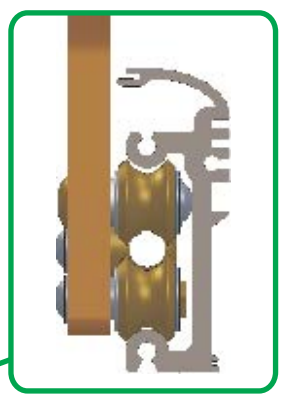
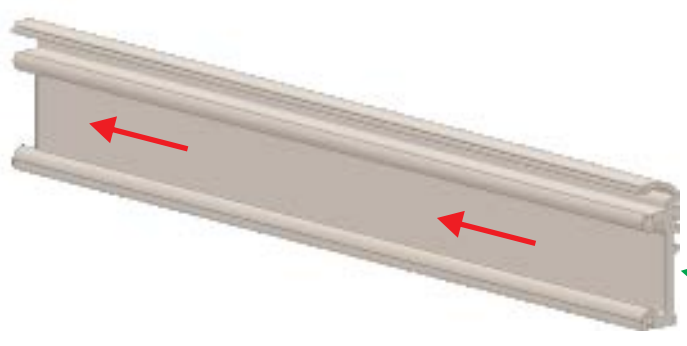
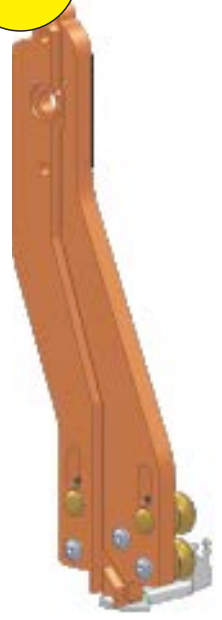

4.4

Adjustment of roller guide

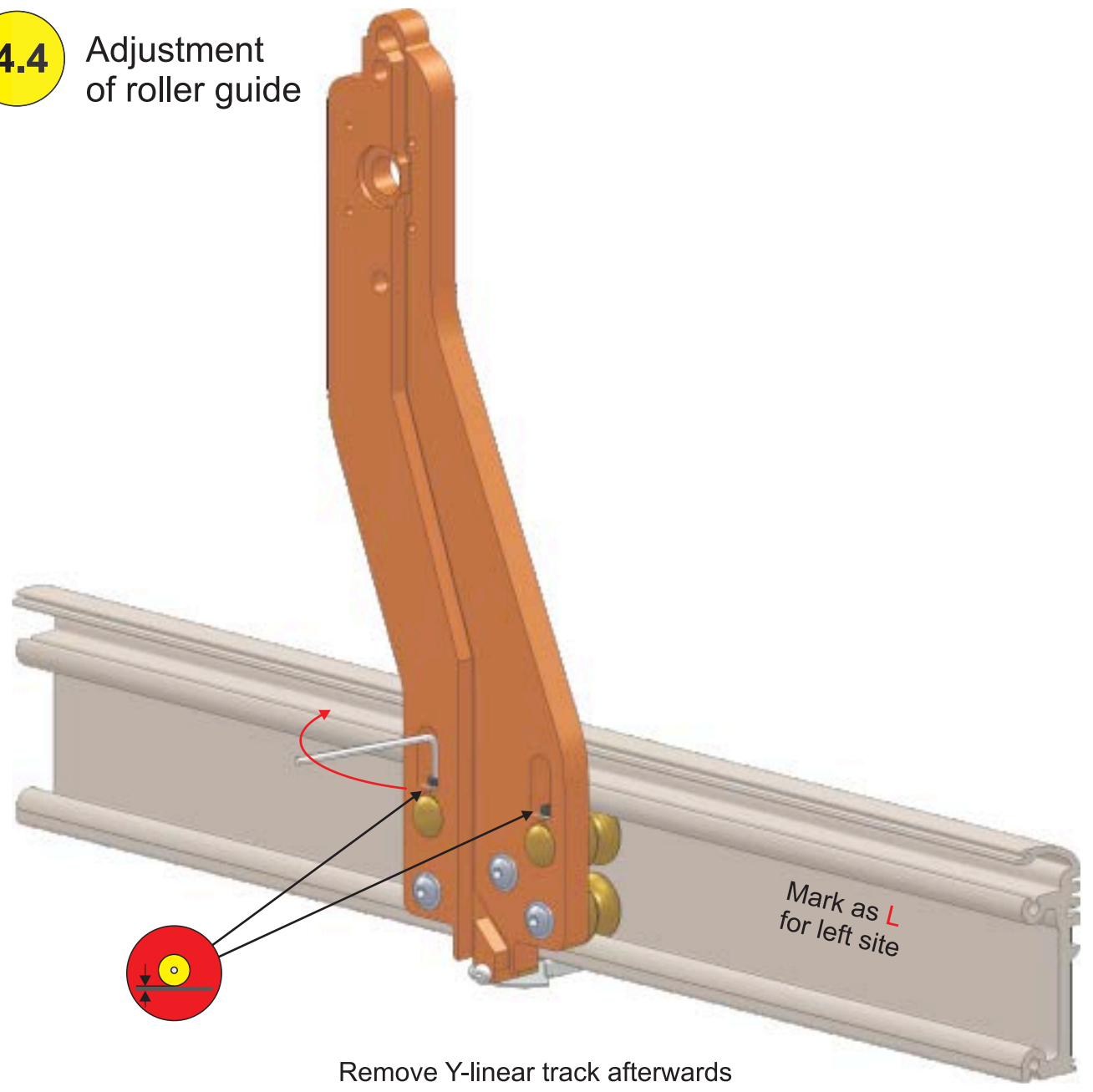

Remove Y-linear track afterwards

4.5

Y-lead screw nut alignment

Check lead screw edge for burr and remove

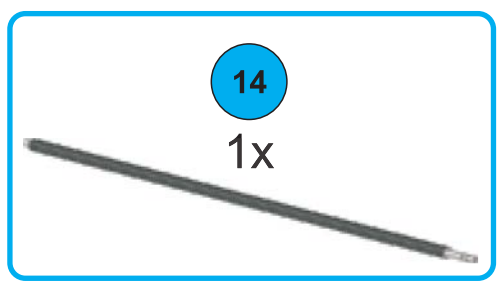

$x = y$

2. Play in lead screw nut must be averaged.

$x = y$

1. Lead screw must be parallel to outer edge.

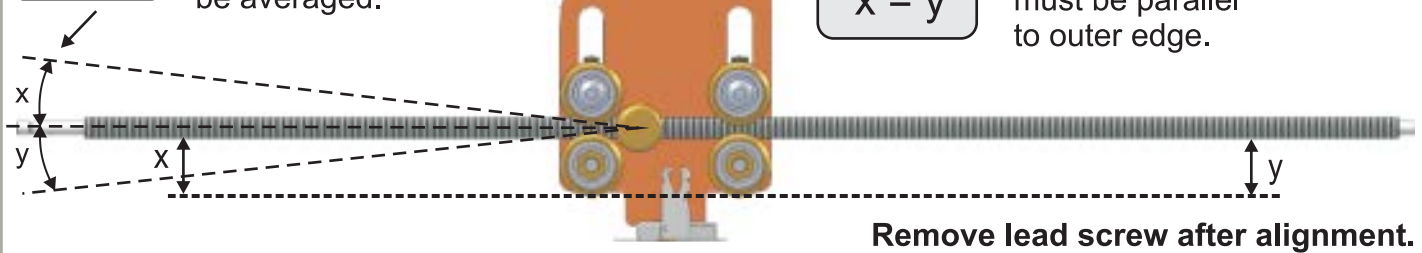

Remove lead screw after alignment.

5



Gantry assembly

5.1

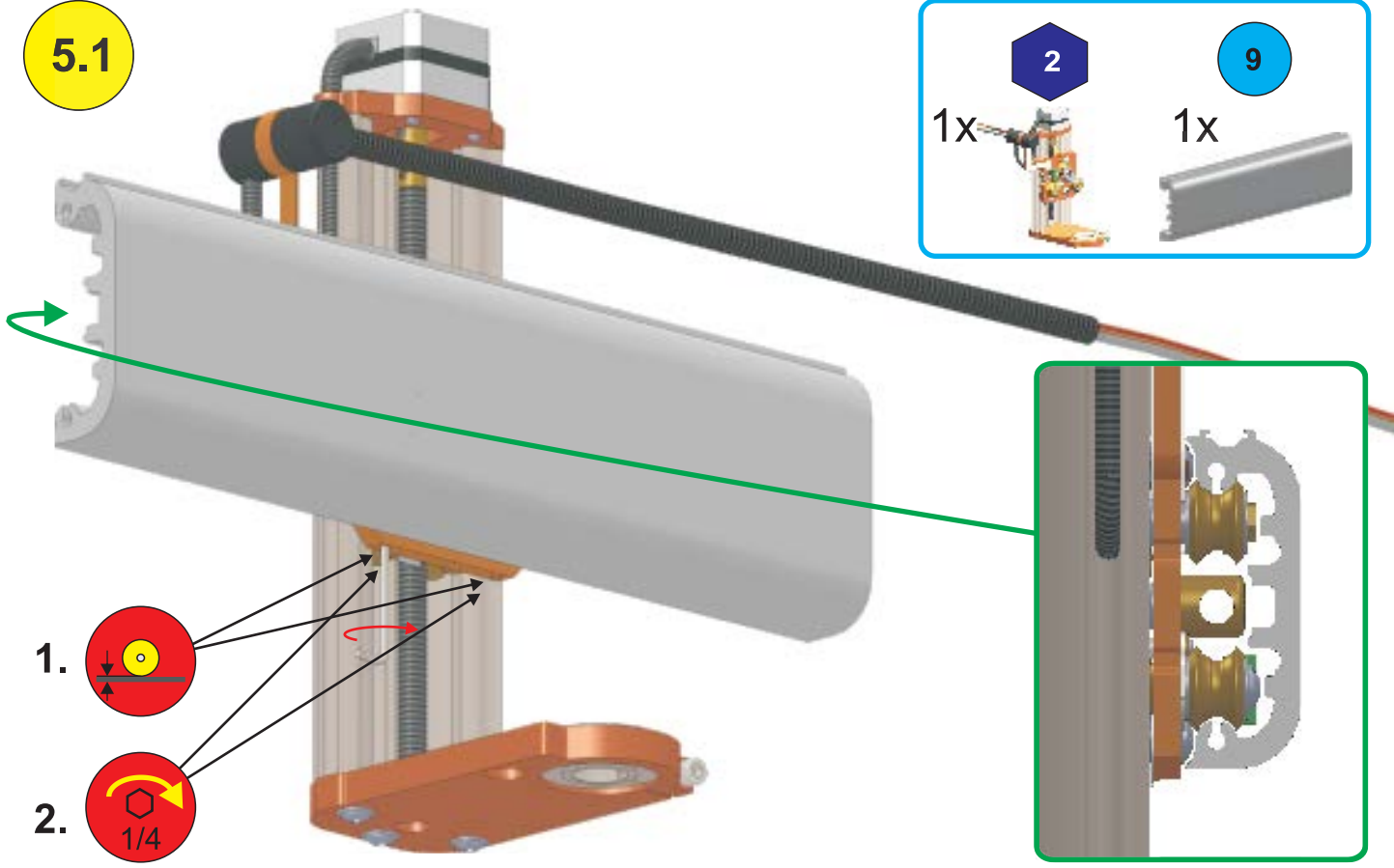
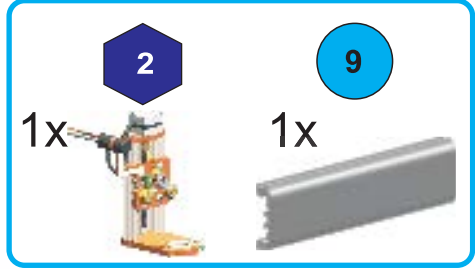

5.2

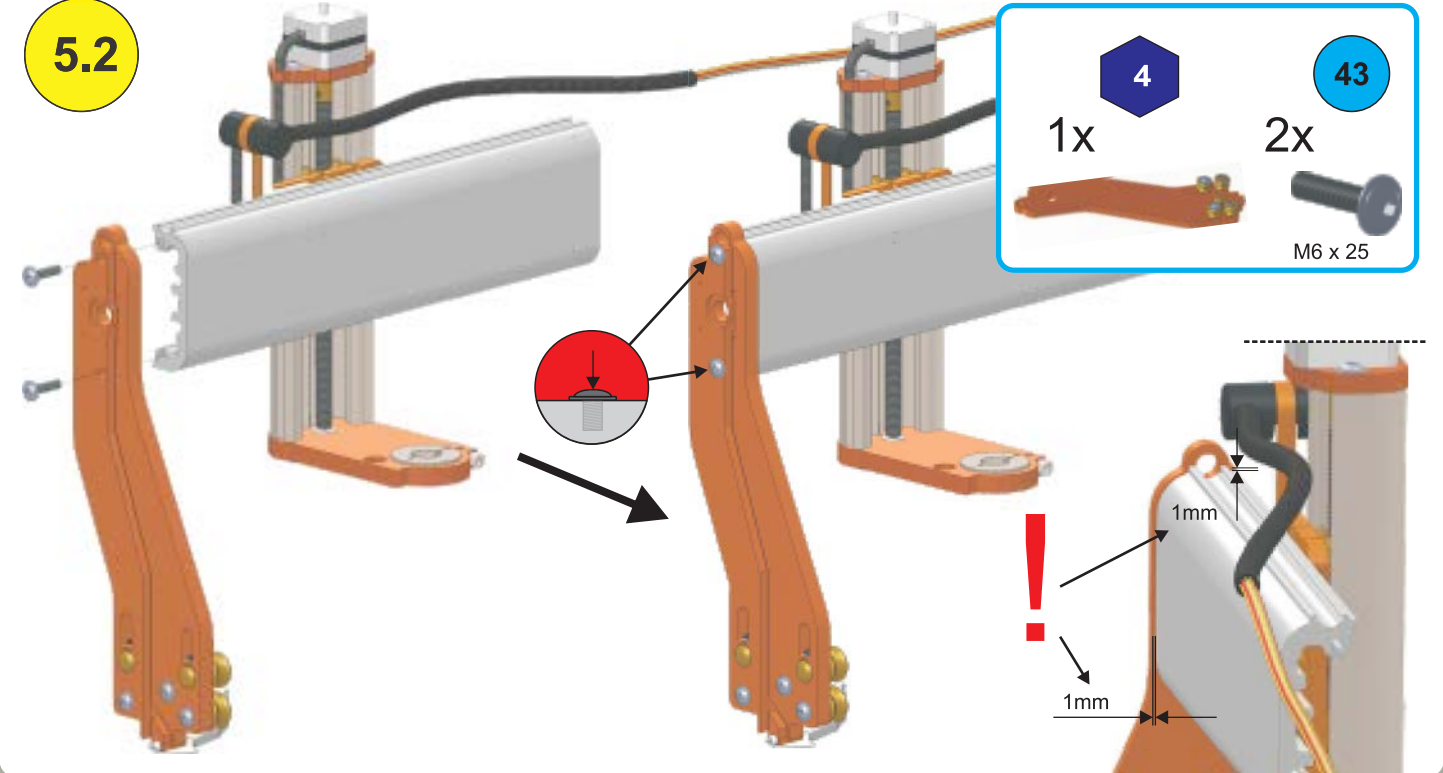
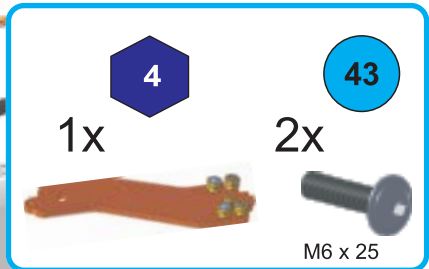

5.3

X-motor cable installation

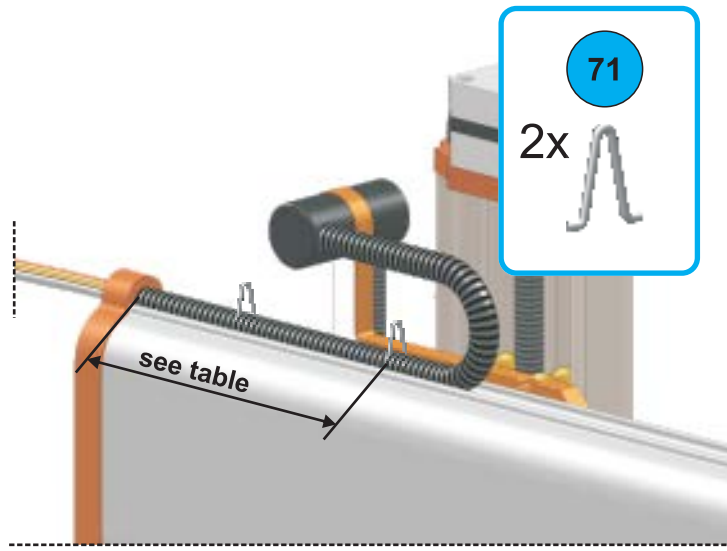

71
2x

Type	Distance
S300	120 mm
S420	155 mm
S600	205 mm
S840	280 mm

5.4

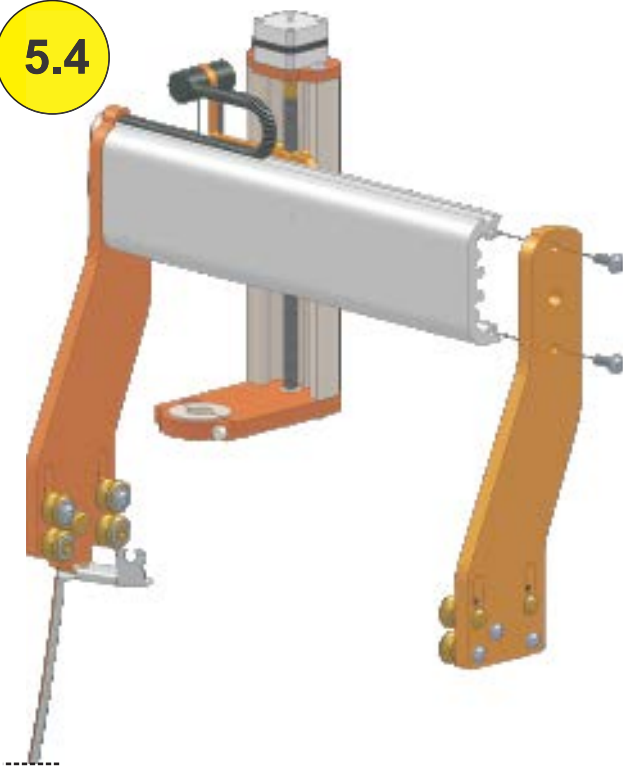

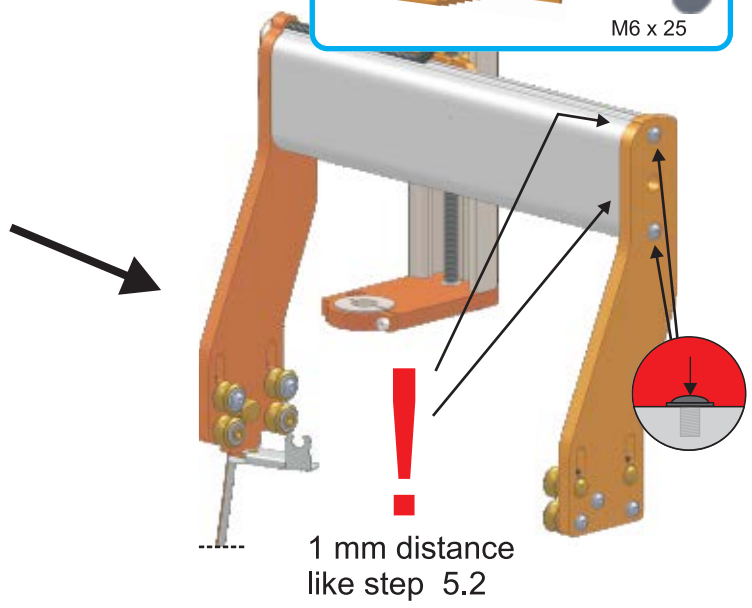

3
1x

43
2x
M6 x 25

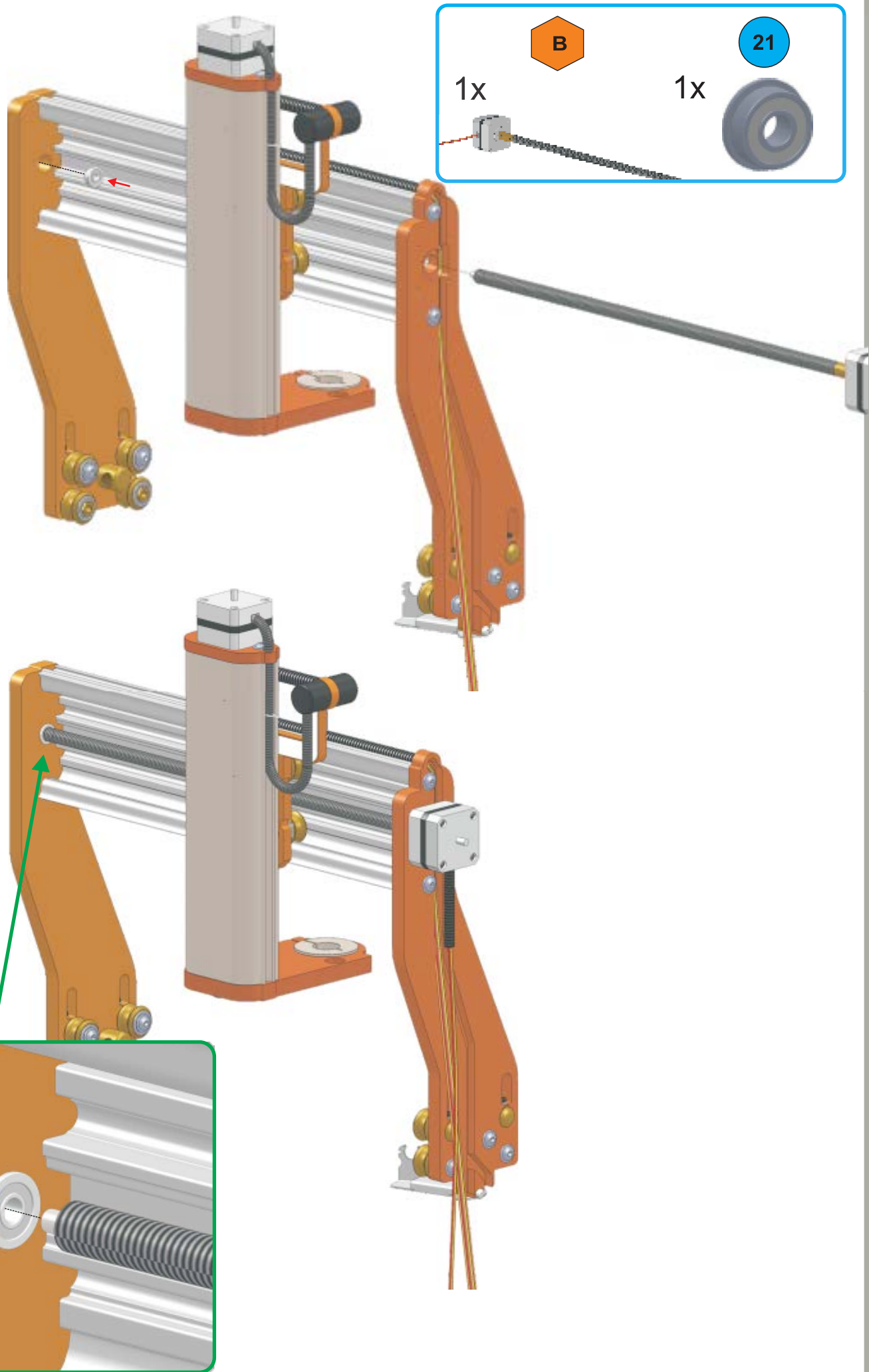

5.5



1x  B

1x  21

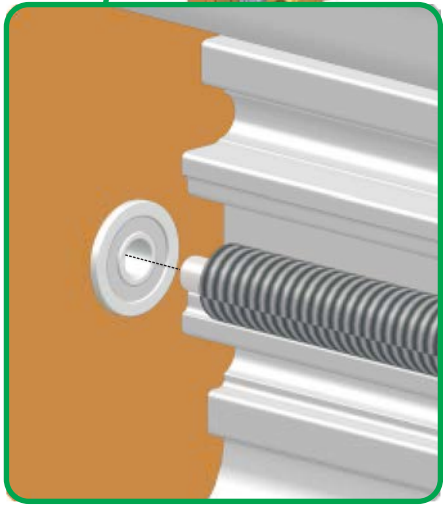

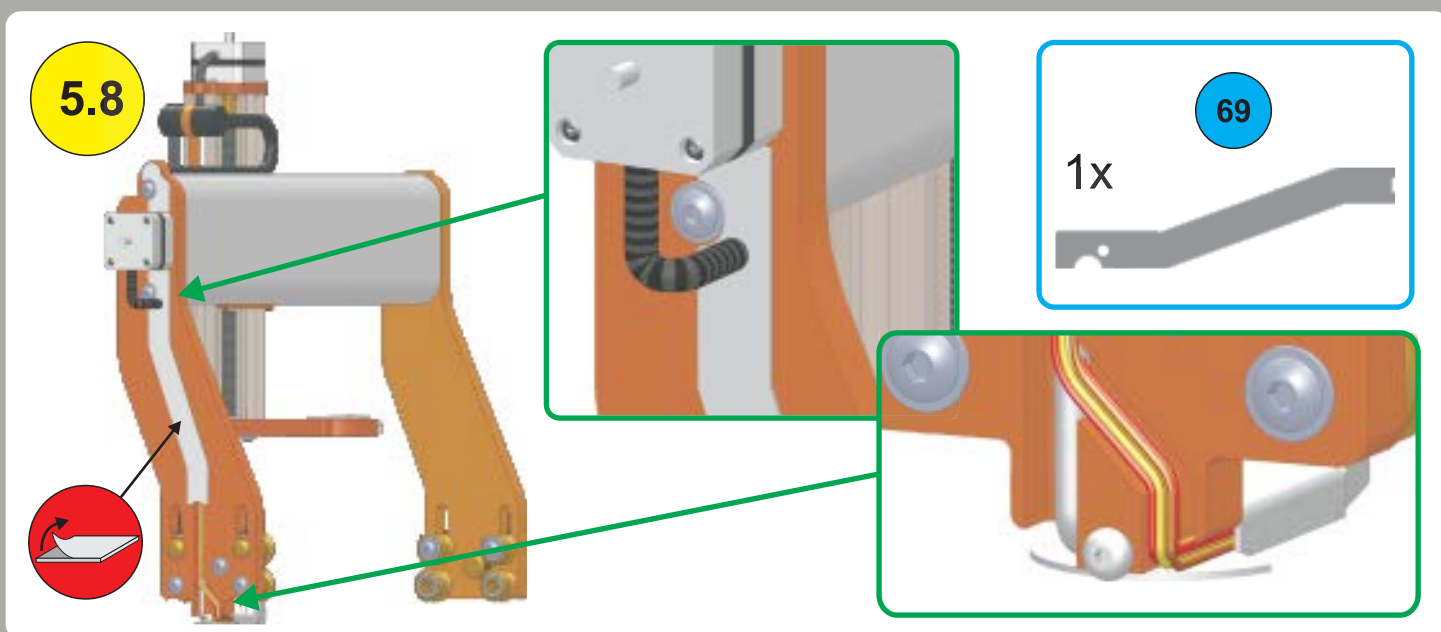
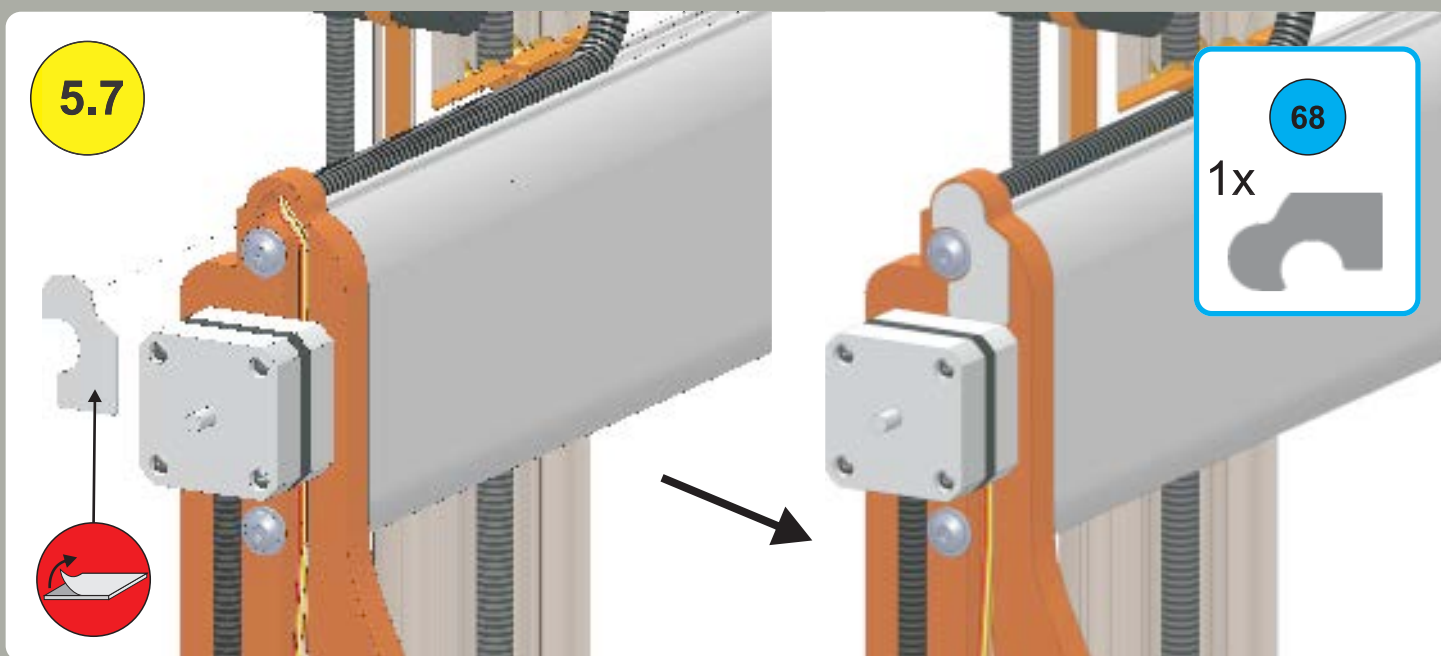
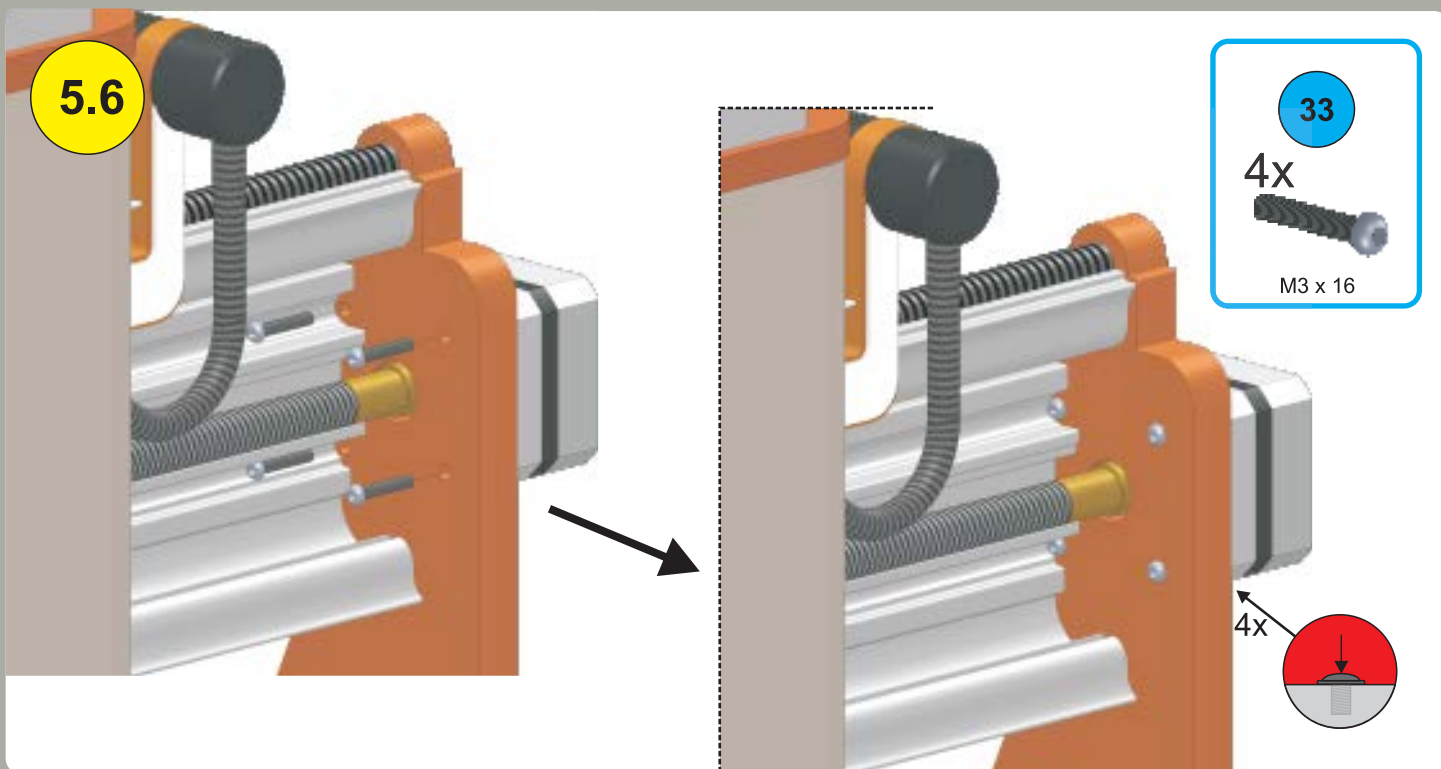

5.9

70
1x

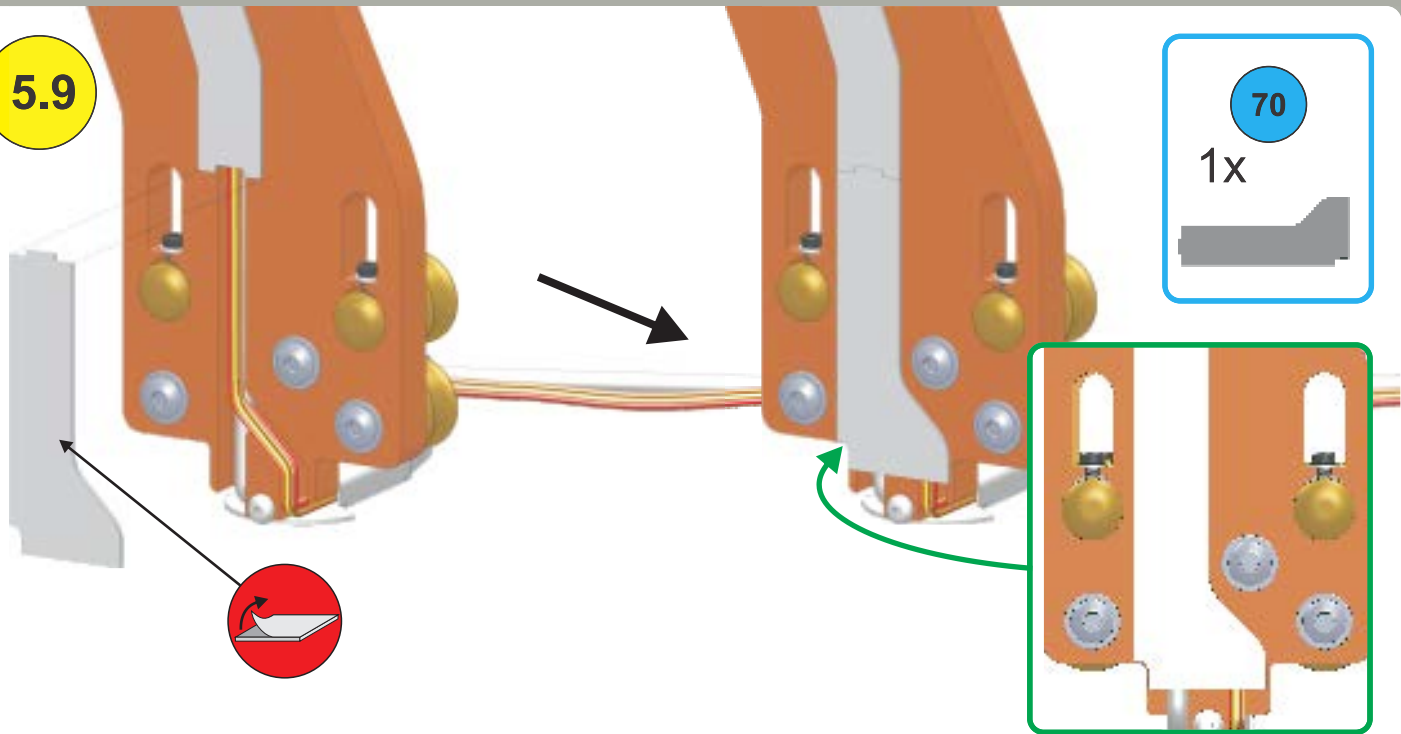

5.10

37
1x

89
1x

ø 10 x 1.5

S300 = 350 mm / S420 = 470 mm
S600 = 610 mm / S840 = 830 mm

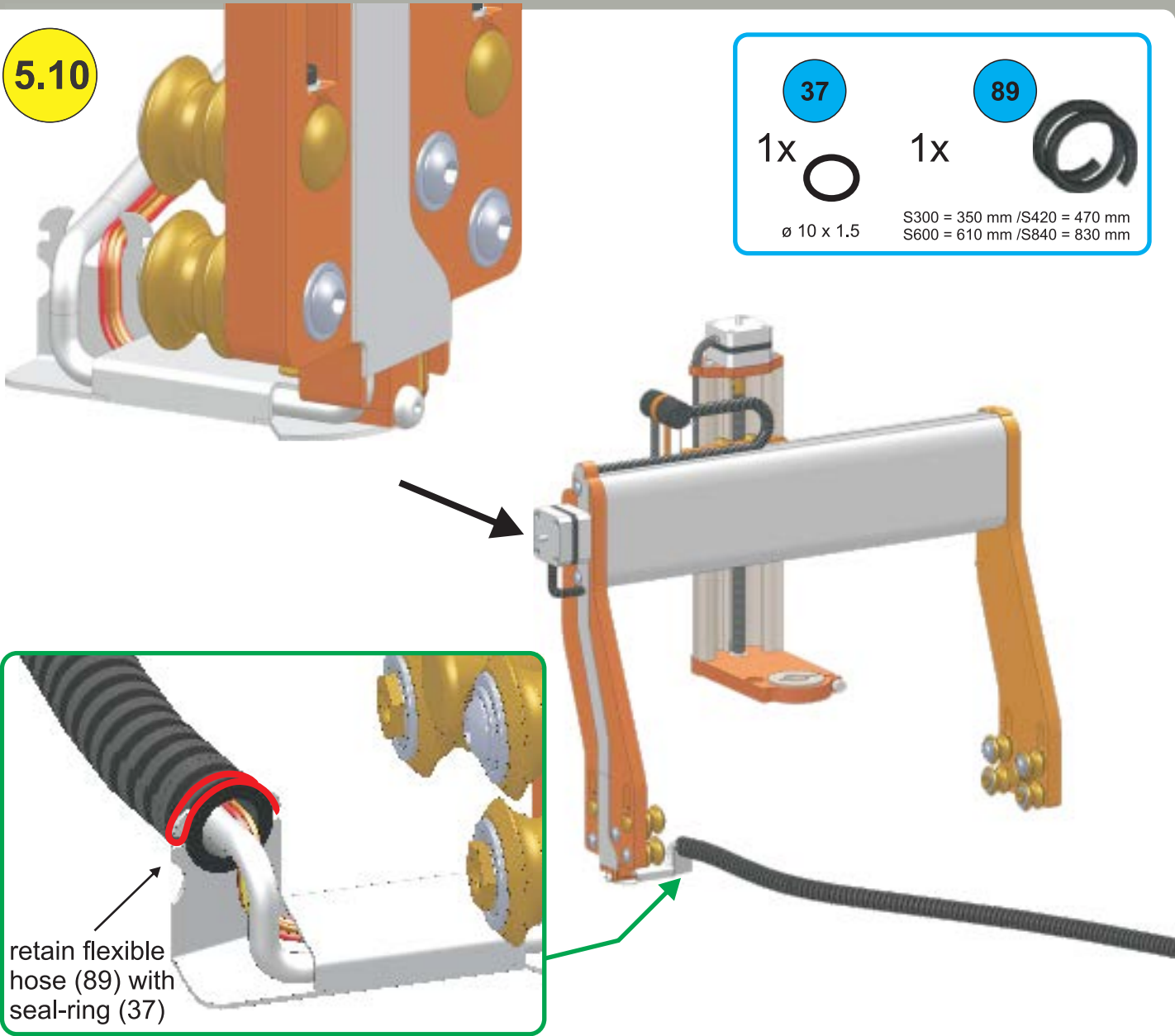



retain flexible hose (89) with seal-ring (37)

C Motor Y-axis

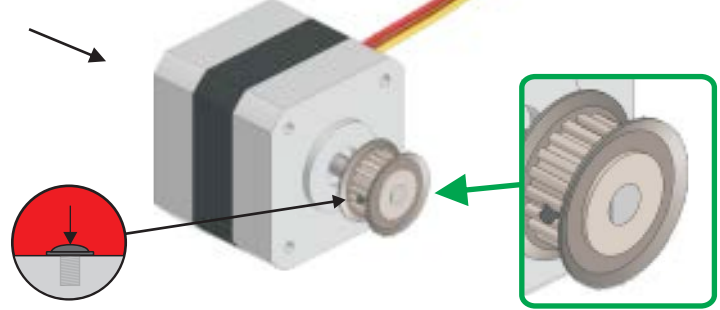
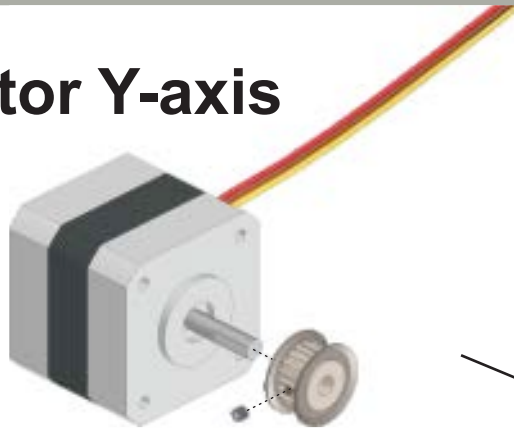
C.1





- 44
 1x

 M3 x 5
- 62
 1x

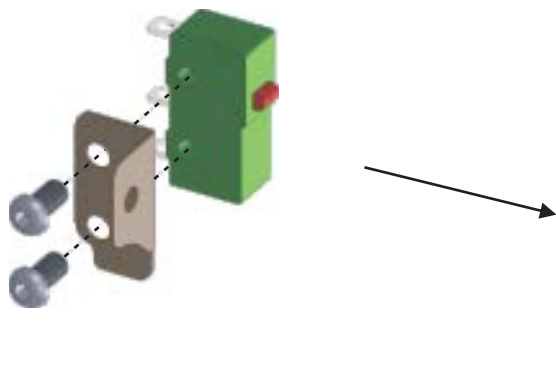
- 83
 1x

D End switch Y-axis

D.1





- 28
 1x

- 31
 2x

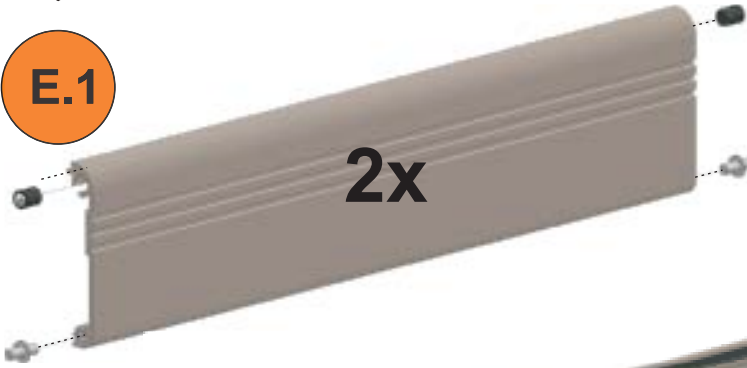
 M3 x 6
- 91
 1x

E Cover Y-axis

E.1



- 64
 4x

- 11
 2x

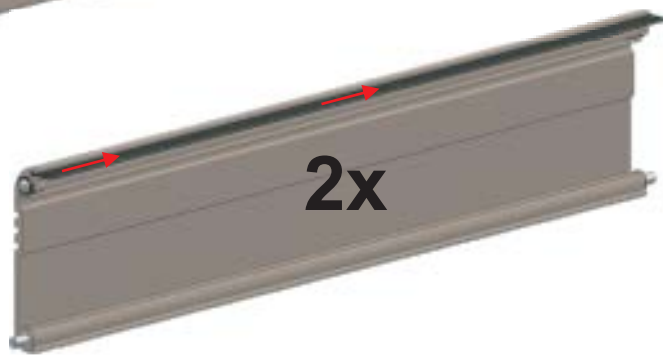
- 63
 4x

E.2

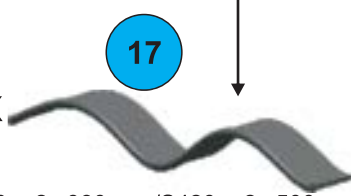

Do not stretch before cutting!











- 17
 2x

- S300 = 2x 380 mm/S420 = 2x 500 mm
 S600 = 2x 680 mm/S840 = 2x 920 mm

6 Base frame



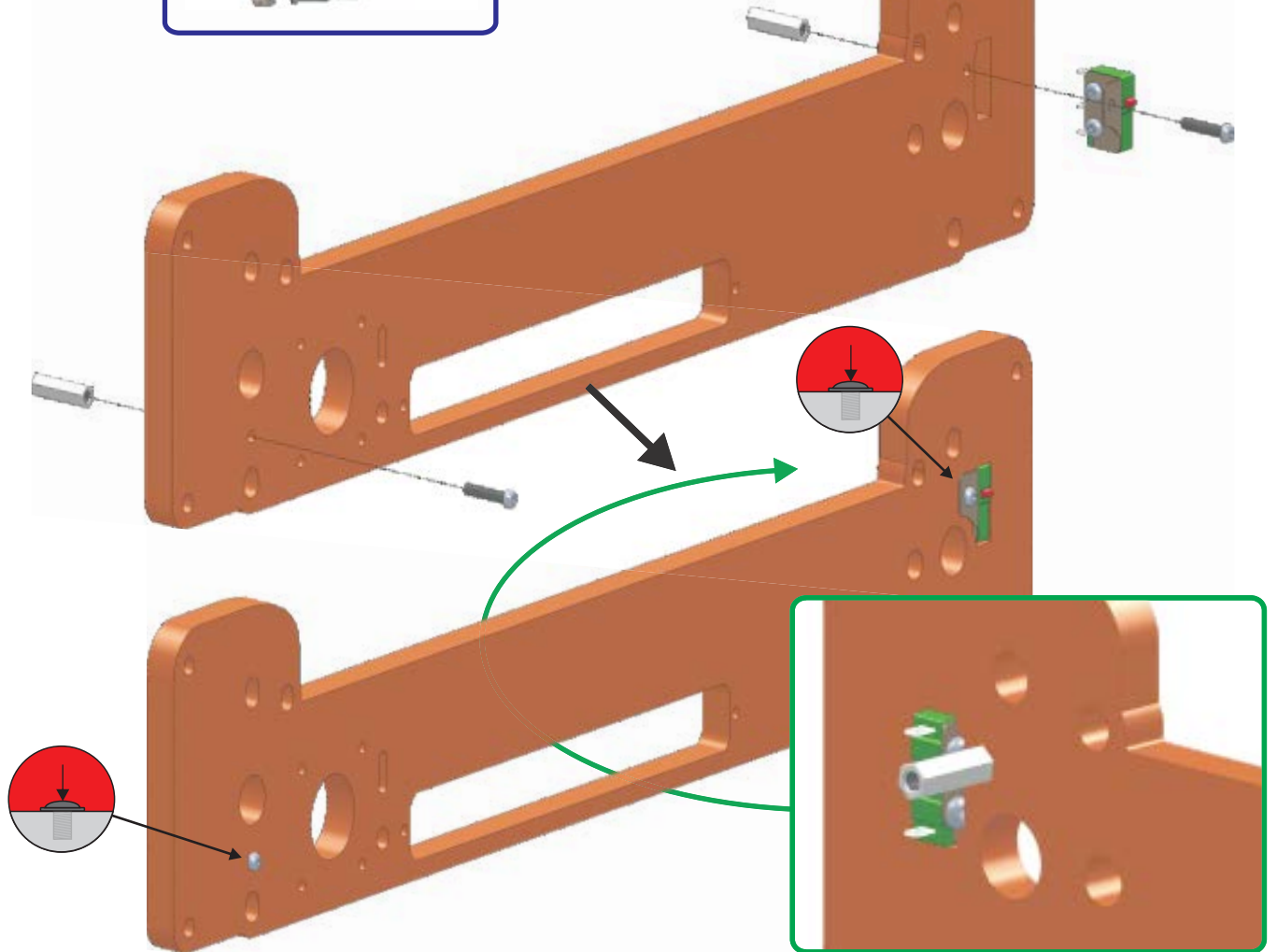

6.1



 1x	 1x	 2x	 2x
		 M3 x 12	 M3 x 15



6.2

 1x	 4x
	 M3 x 12

